

KEY MAP NO. 1

REVISIONS		
DATE	NAME	NO.

This sheet has been drawn using Computer Aided Drafting/Design (CAD/D).

REPLY TO: DEPARTMENT OF THE TREASURY
 DIVISION OF TAXATION
 PROPERTY ADMINISTRATION
 APPROVED AS A TAX MAP PURSUANT TO THE AUTHORITY OF
 N.J.S.A. 54:1-15 & 54:26-1
 FOR THE DIRECTOR, DIVISION OF TAXATION
 THOMAS J. KELLY, CHIEF, LOCAL PROPERTY, FIELD ASSISTANT: C.T.A.
James D. Berry SUPERVISING FIELD REPRESENTATIVE: C.T.F.
 DATE: JUL 11 2011 SERIAL NO. 971

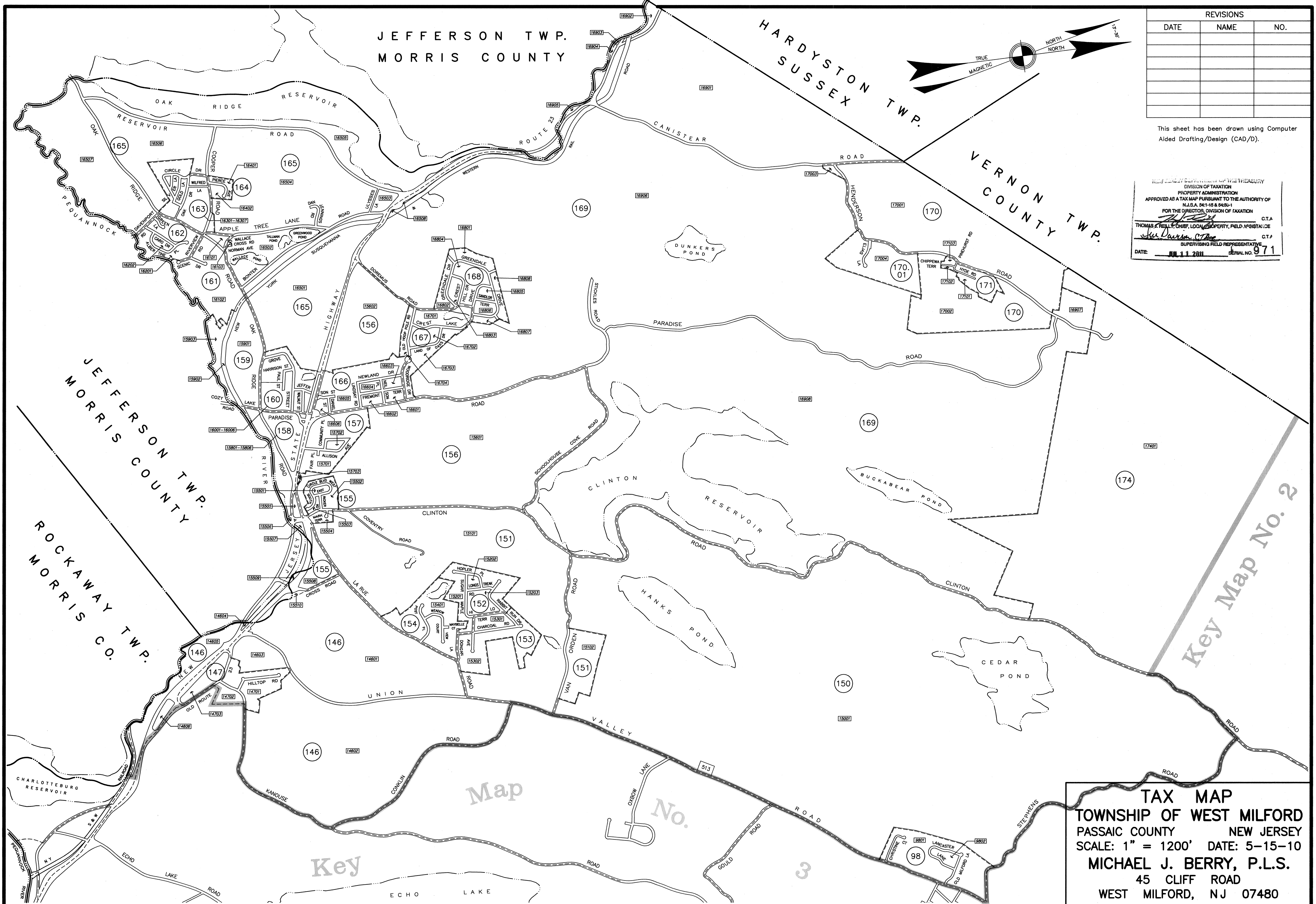

TAX MAP
TOWNSHIP OF WEST MILFORD
 PASSAIC COUNTY NEW JERSEY
 SCALE: 1" = 1200' DATE: 5-15-10
MICHAEL J. BERRY, P.L.S.
 45 CLIFF ROAD
 WEST MILFORD, NJ 07480

KEY MAP NO. 1