

REVISIONS		
DATE	NAME	NO.
3 - 26 - 13	Michael J. Berry	21787
3 - 22 - 17	Stephen P. Eid	30081

NEW JERSEY DEPARTMENT OF THE TREASURY
 DIVISION OF TAXATION
 PROPERTY ADJUDICATION
 APPROVED AS A TAX MAP PURSUANT TO THE AUTHORITY OF
 N.J.S.A. 52:18-3 & 52:23
 FOR THE DIRECTOR, DIVISION OF TAXATION
 _____ C.T.A.
 THOMAS J. REILLY, CHIEF, LOCAL PROPERTY, FIELD ASSISTANCE C.T.A.
 _____ SUPERVISING FIELD REPRESENTATIVE
 DATE: 11/17/2011 SERIAL NO. 971

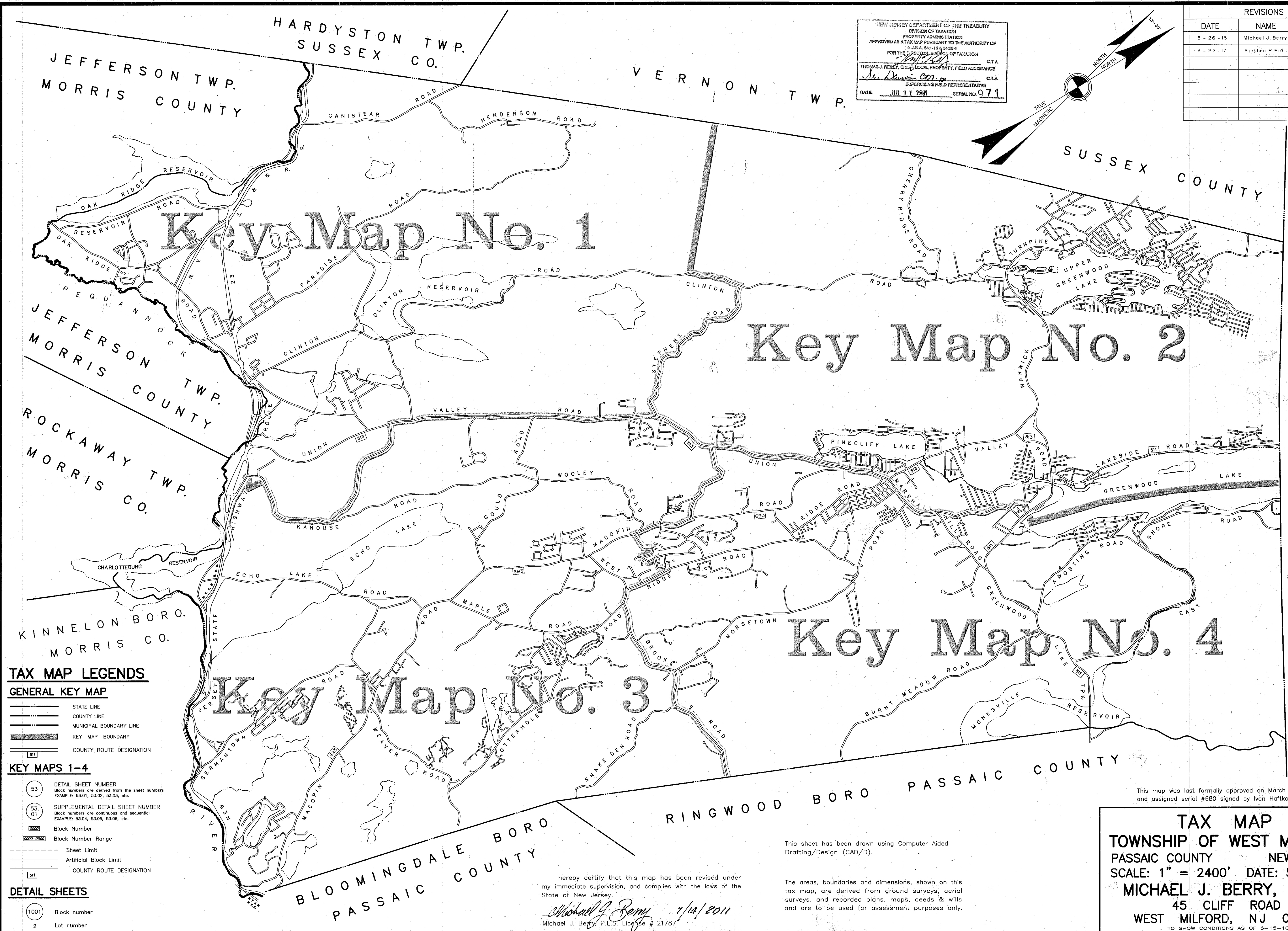
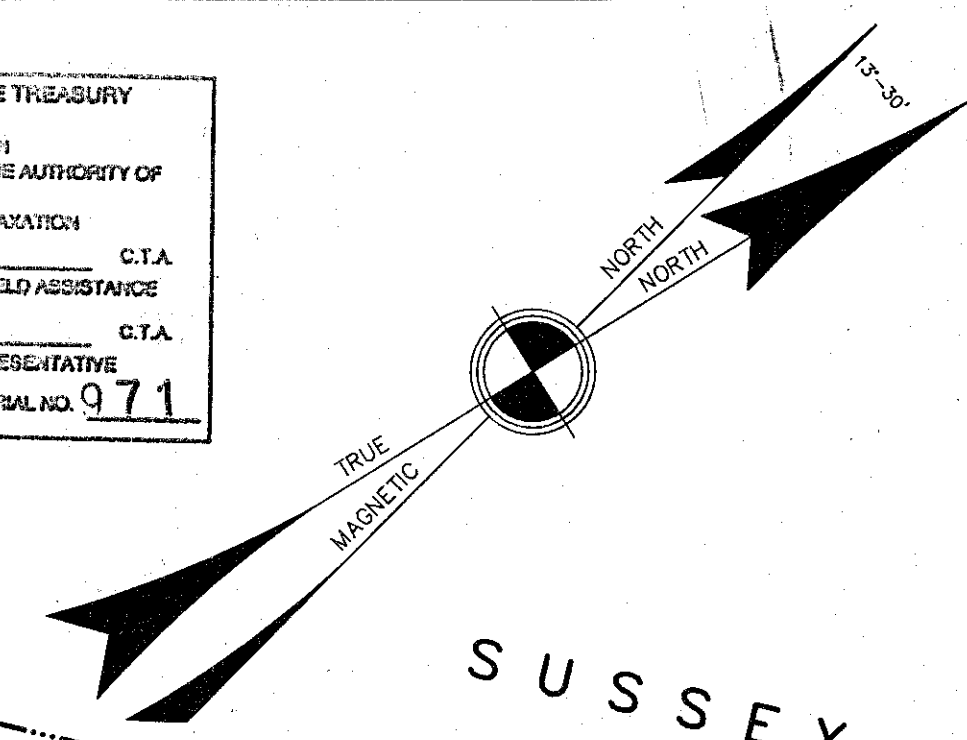

TAX MAP LEGENDS

GENERAL KEY MAP

- STATE LINE
- COUNTY LINE
- MUNICIPAL BOUNDARY LINE
- KEY MAP BOUNDARY
- COUNTY ROUTE DESIGNATION

KEY MAPS 1-4

- DETAIL SHEET NUMBER
Block numbers are derived from the sheet numbers
EXAMPLE: 53.01, 53.02, 53.03, etc.
- SUPPLEMENTAL DETAIL SHEET NUMBER
Block numbers are continuous and sequential
EXAMPLE: 53.04, 53.05, 53.06, etc.
- Block Number
- Block Number Range
- Sheet Limit
- Artificial Block Limit
- COUNTY ROUTE DESIGNATION

DETAIL SHEETS

- Block number
- Lot number

I hereby certify that this map has been revised under my immediate supervision, and complies with the laws of the State of New Jersey.
Michael J. Berry 1/14/2011
 Michael J. Berry, P.L.S. License # 21787

This sheet has been drawn using Computer Aided Drafting/Design (CAD/D).

The areas, boundaries and dimensions, shown on this tax map, are derived from ground surveys, aerial surveys, and recorded plans, maps, deeds & wills and are to be used for assessment purposes only.

This map was last formally approved on March 22, 1988 and assigned serial #680 signed by Ivan Haftkowycz

TAX MAP
 TOWNSHIP OF WEST MILFORD
 PASSAIC COUNTY NEW JERSEY
 SCALE: 1" = 2400' DATE: 5-15-10
MICHAEL J. BERRY, P.L.S.
 45 CLIFF ROAD
 WEST MILFORD, NJ 07480
TO SHOW CONDITIONS AS OF 5-15-10

ORANGE COUNTY NEW YORK