

REVISIONS		
DATE	NAME	NO.
2-02-04	Michael J. Berry	21787
2-03-04	"	"
3-09-04	"	"
1-20-11	"	"
3-10-14	"	"
4-30-18	Stephen P. Eid	30081

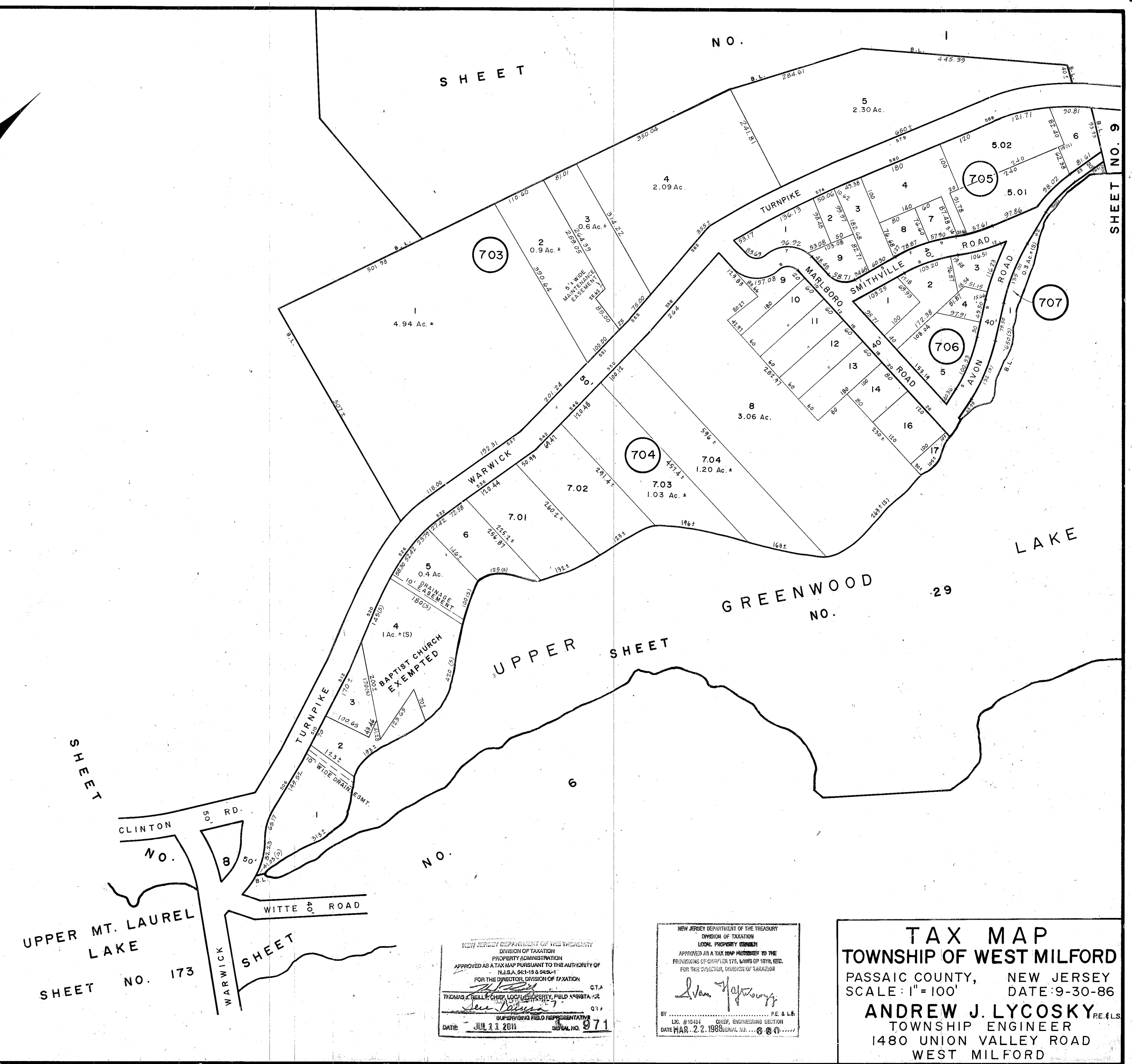
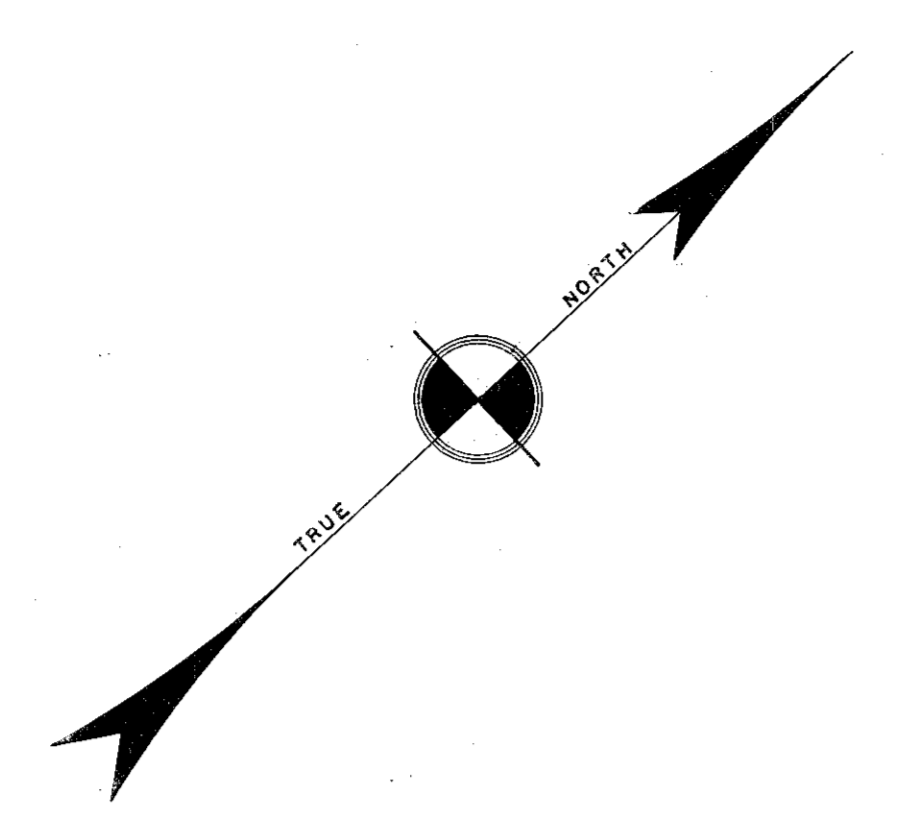

NEW JERSEY DEPARTMENT OF TREASURY
 DIVISION OF TAXATION
 PROPERTY ADMINISTRATION
 APPROVED AS A TAX MAP PURSUANT TO THE AUTHORITY OF
 N.J.S.A. 54:1-15 & 54:1-17
 FOR THE DIRECTOR, DIVISION OF TAXATION
 THOMAS J. HILL, CHIEF, LOCAL PROPERTY FIELD REPRESENTATIVE
 DATE: JUL 23 2011 SERIAL NO. 971

NEW JERSEY DEPARTMENT OF THE TREASURY
 DIVISION OF TAXATION
 LOCAL PROPERTY SECTION
 APPROVED AS A TAX MAP PURSUANT TO THE
 PROVISIONS OF CHAPTER 175, LAWS OF 1979, ETC.
 FOR THE DIRECTOR, DIVISION OF TAXATION
 Andrew J. Lycosky
 BY: Andrew J. Lycosky, P.E. & L.S.
 LIC. #16451 CHIEF, ENGINEERING SECTION
 DATE: MAR. 22 1908 SERIAL NO. 684

TAX MAP
TOWNSHIP OF WEST MILFORD
 PASSAIC COUNTY, NEW JERSEY
 SCALE: 1" = 100' DATE: 9-30-86
ANDREW J. LYCOSKY, P.E. & L.S.
 TOWNSHIP ENGINEER
 1480 UNION VALLEY ROAD
 WEST MILFORD